

# Acessórios de Junta Mecânica FFD

## Ligação Flangeada

### FLANGED SOCKET

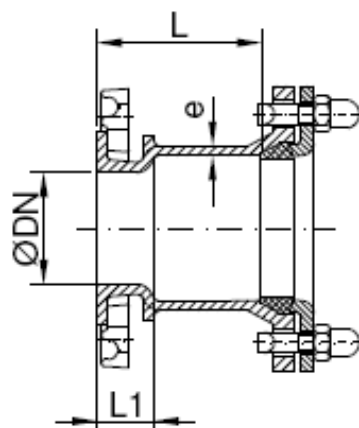

#### Características:

- Pressão de trabalho  
PN 10 - PN16 - PN25
- Pintura epoxy > 250microns.
- Adequada para águas de consumo humano.
- DN 60-1000
- Fundição Dúctil GJS-500-7 de acordo com a EN1563.

#### Design Features:

- PN 10-16-25 operating pressure.
- Coating paint epoxy 250 microns as a minimum.
- Suitable for water human consumption.
- DN 60-1000
- Ductil Iron GJS-500-7 according to EN1563.

DN	DIMENSÕES MM			PESO (KG)		
	L	L1	e	PN 10	PN 16	PN 25
60	97	41	7	5.5	5.5	5.5
80	97	41	7	7.7	7.7	8.2
100	94	41	7.2	9.6	9.6	10.7
125	105	42	7.5	11.8	11.8	13.4
150	108	45	7.8	14.8	14.8	16.4
200	113	50	8.4	21	20.5	23.4
250	118	55	9	28.4	28.8	32.3
300	133	60	9.6	37.5	38.7	42.5
350	139	66	10.2	48	50	56
400	141	68	10.8	55	59	66.7
450	157	74	11.4	67.1	73.6	80.3
500	161	78	12	80	93	99.3
600	178	85	13.2	106.2	133.5	134.6
700	184	89	14.4	153	171	179.5
800	200	95	15.6	205	228	235.3
900	210	90	16.8	257	281	341
1000	220	80	18	293	324	458

#### Ensaio:

- De acordo com EN545.

#### Test:

- According to EN545.