

Acessórios de Junta Mecânica FFD

Junta Desmontagem

DISMANTLING JOINT

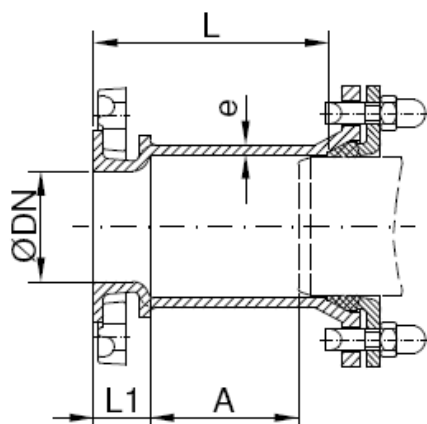

Características:

- Pressão de trabalho PN 10 - PN16 – PN25
- Pintura epoxy > 250microns.
- Adequada para águas de consumo humano.
- DN 60-600
- Fundição Dúctil GJS-500-7 de acordo com a EN1563.

Design Features:

- PN 10-16-25 operating pressure.
- Coating paint epoxy 250 microns as a minimum.
- Suitable for water human consumption.
- DN 60-600
- Ductil Iron GJS-500-7 according to EN1563.

DN	DIMENSÕES MM				PESO (KG)		
	L	L1	A	e	PN 10	PN 16	PN 25
60	166	41	110	7	6.5	6.5	6.5
80	178	41	120	7	9.1	9.1	9.6
100	175	41	120	7.2	11.3	11.3	12.4
125	175	42	120	7.5	13.7	13.7	15.3
150	198	45	140	7.8	17.7	17.7	19.3
200	223	50	160	8.4	26	25.5	28.4
250	248	55	180	9	36.2	36.5	40
300	273	60	200	9.6	48	49.3	53
350	289	66	210	10.2	61.8	63.9	69.9
400	301	68	220	10.8	72.7	76.8	84.5
450	333	74	245	11.4	90	96.6	103.3
500	363	78	270	12	110.7	123.7	130
600	383	85	285	13.2	146.9	174.2	175.3

Ensaio:

- De acordo com EN545.

Test:

- According to EN545.

